



**HIGH OUTPUT**

495 Turnpike Street  
Canton, MA 02021

781-364-1800  
www.highoutput.com

Drawing Name:

**Charles River Studios  
Studio B  
Floorplan**

Version: 1 Plate #: 1

Date Created: November 20, 2019

Drwn By: N. Jewett

Scale: 1/8" = 1'-0"  
(Printed at 100% on 8.5"x11" Paper)

Client:

Account Manager:

Project Manager:

Event Date/Location:

**Notes:**

- Total Area ~3500 sq. ft.
- Steel Working Height:  
24' to high steel  
21' to low steel
- Overhead Door to Studio B:  
11'10" h x 9'10" wide
- Power: 200a/3ph
- Standard Flat Black painted floor surface over concrete.
- Standard flat white painted seamless cyc on two walls and the adjacent floor area.

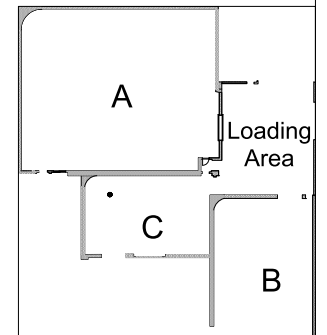
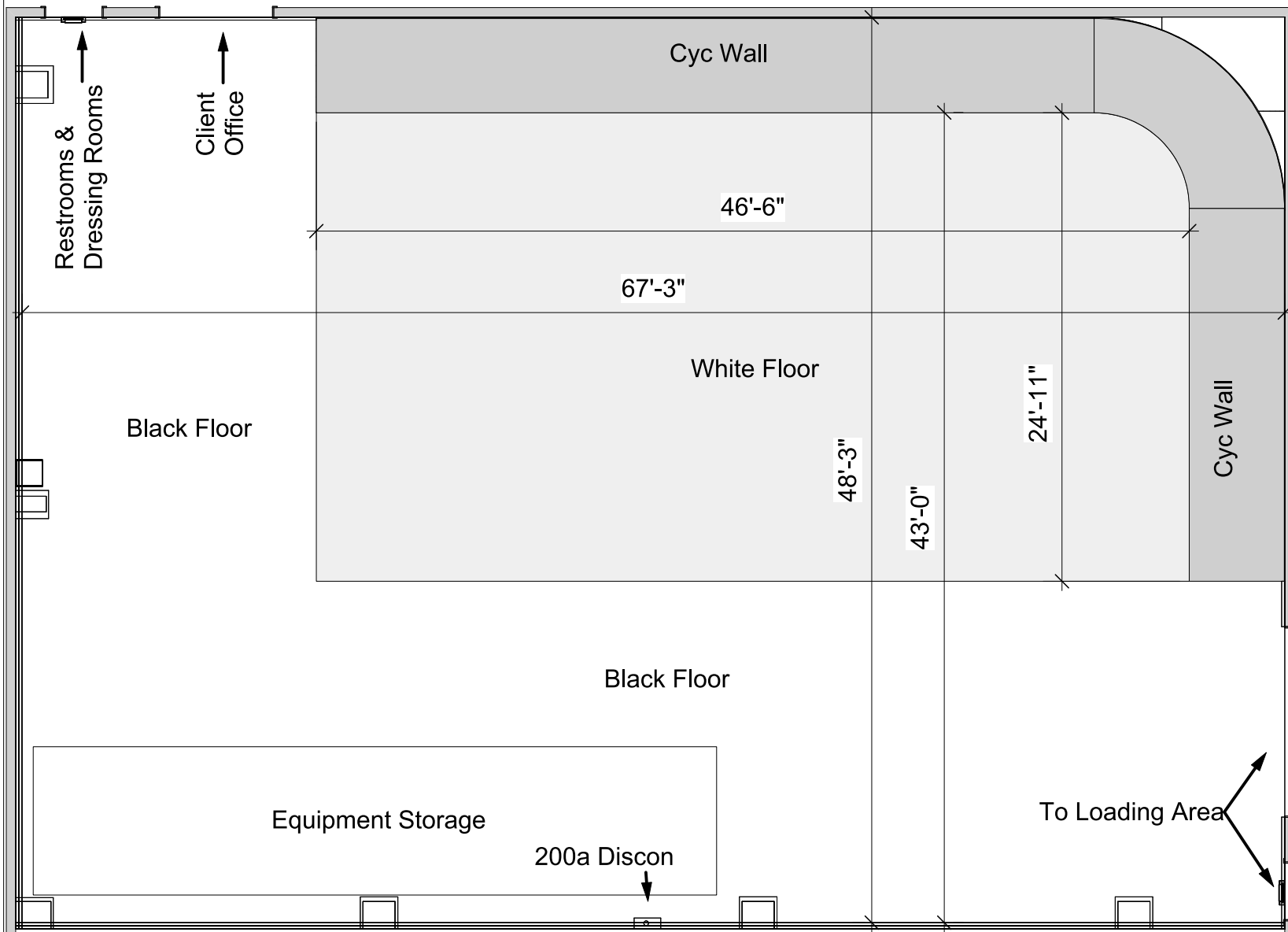



**HIGH OUTPUT**

495 Turnpike Street  
Canton, MA 02021

781-364-1800  
www.highoutput.com

Drawing Name:

**Charles River Studios  
Studio B  
Overhead**

Version: 1 Plate #: 1

Date Created: November 20, 2019

Dwn By: N. Jewett

Scale: 1/8" = 1'-0"  
(Printed at 100% on 8.5"x11" Paper)

Client:

Account Manager:

Project Manager:

Event Date/Location:

**Notes:**

- Total Area ~3500 sq. ft.
- Steel Working Height:  
24' to high steel  
21' to low steel
- Overhead Door to Studio B:  
11'10" h x 9'10" wide
- Power: 200a/3ph
- Standard Flat Black painted floor surface over concrete.
- Standard flat white painted seamless cyc on two walls and the adjacent floor area.

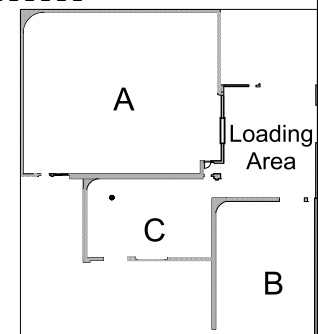
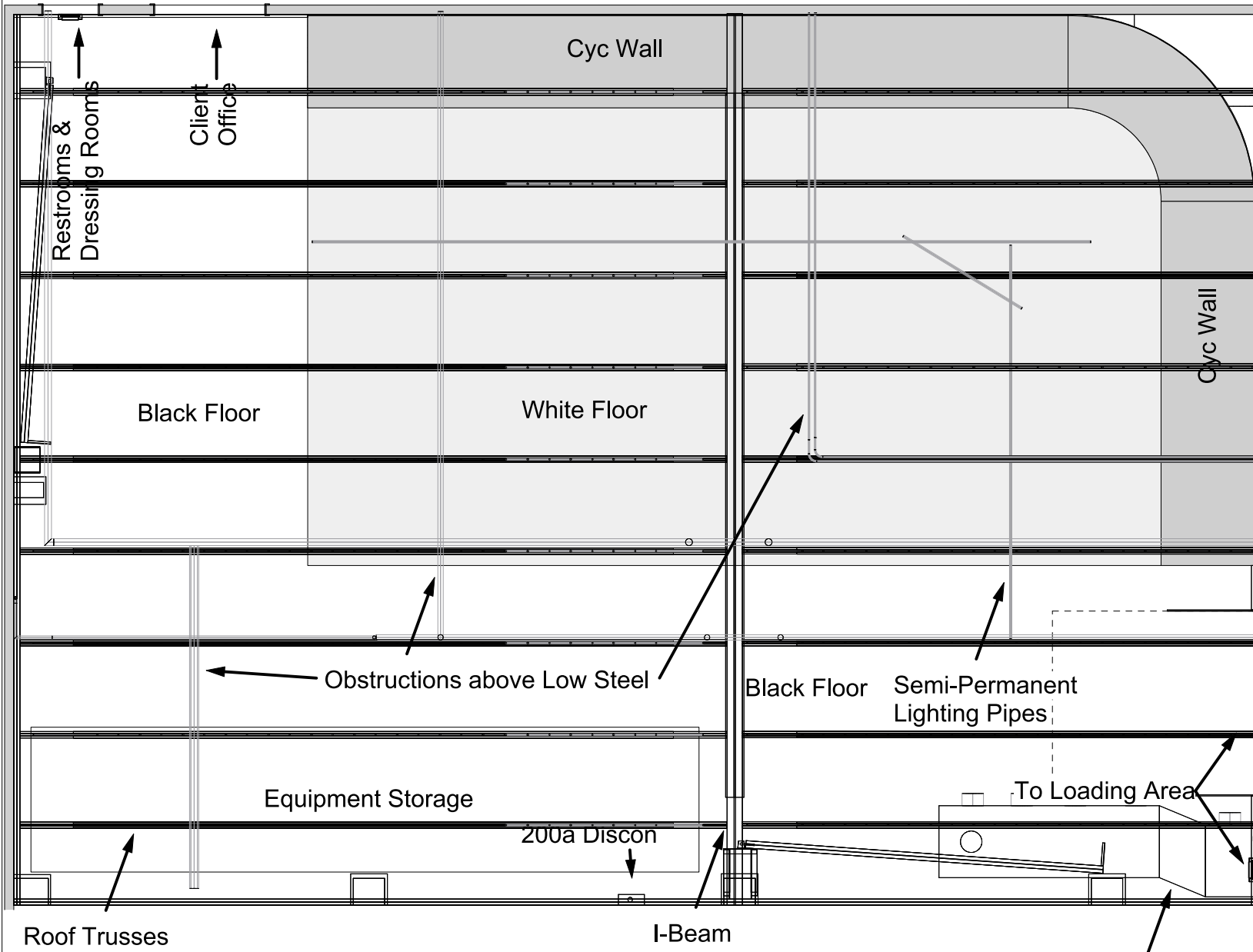

3-Dimensional Vectorworks Drawing available upon request